

1984-2099 CALENDAR, JULIAN DATE AND TIME, 4 OR 6 DIGIT AND 12 OR 24 HOUR

DIGITAL MONTH

DAC-312407

0.7" DISPLAY
35ft VISIBILITY
20"x 14"x 1.5"

DAC-312412

1.2" DISPLAY
55ft VISIBILITY
21"x 21"x 1.5"

DAC-312420

2.0" DISPLAY
85ft VISIBILITY
40"x 30"x 1.5"

THE CURRENT DAY FLASHES AT A ONE SECOND RATE

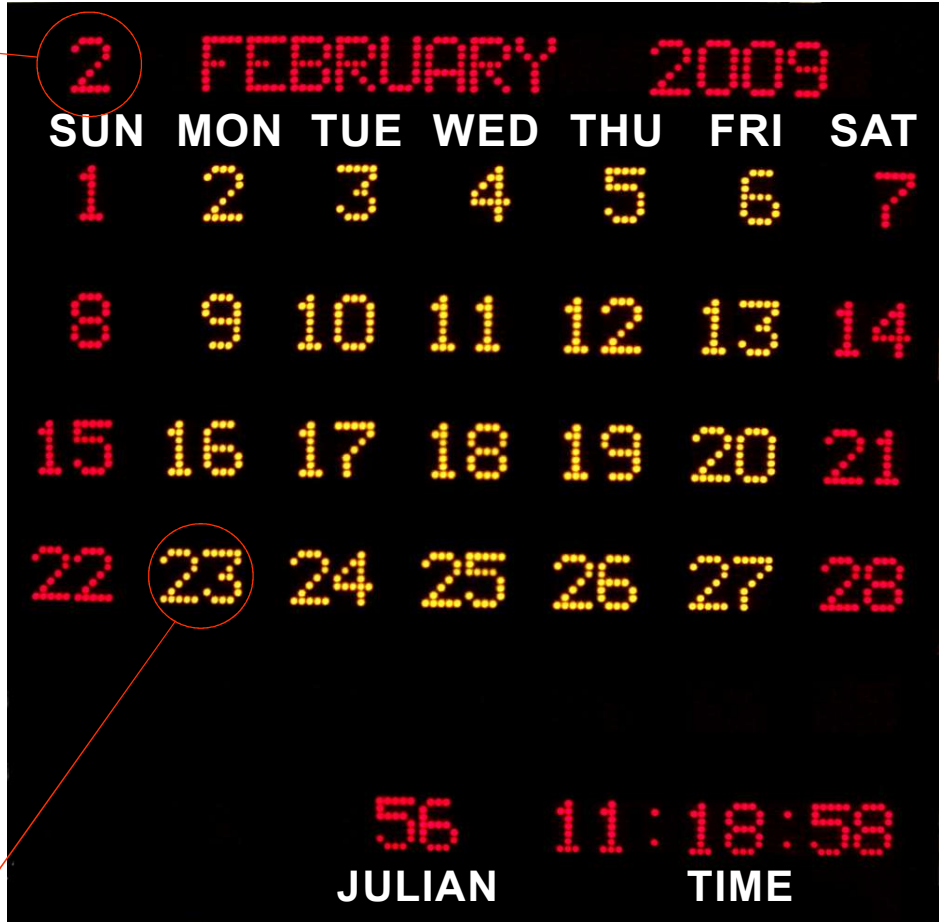

DAC-3124XX

SPECIFICATIONS

DISPLAY TYPE:-----	DIGITAL and 5x7 DOT-MATRIX
CHARACTER HEIGHT: -----	0.7",1.2", OR 2" LED DISPLAYS
VISIBILITY: -----	35ft, 55ft,AND 85ft
POWER REQUIREMENTS:-----	100-240V 47~63Hz (12dc SWITCHING POWER SUPPLY)
FRAME: -----	ALUMINUM (BLACK ANODIZED FINISH)
OPERATING TEMP.: -----	-17° TO 190° F
HUMIDITY: -----	0% TO 95% NON-CONDENSING
OPERATING MODE: -----	12/24 hr SELECTABLE and AUTOMATIC DAYLIGHT

ONE SEC A YEAR ACCURACY (TCXO)*
ALL CLOCKS USE THE DALLAS DS32 SERIES RTC PARTS, AND OUR FIRMWARE CONTROL, TO GET THE ONE SEC A YEAR ACCURACY. **World's Most Accurate RTC**

*May vary based on external temperatures

10 YEAR LITHIUM BATTERY MEMORY BACKUP
AUTOMATIC DAY LIGHT CORRECTION (Standard)
INFRARED REMOTE CONTROL (Standard)

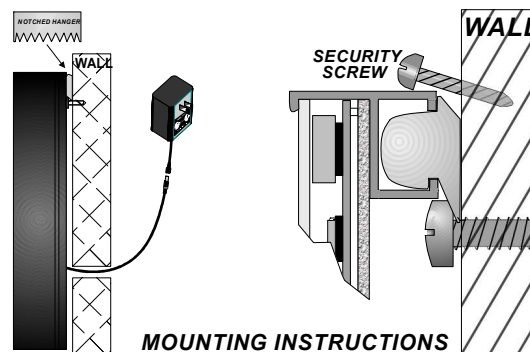

DAC-31 Calendar Setting Instructions With the IRR Remote

NOTE: SETTING IS NOT REQUIRED, ALL REGISTERS HAVE BEEN PRESET, AND THE CLOCK IS RUNNING AT THE CORRECT TIME.

TO OPEN THE REGISTERS FOR SETTING THE (LOAD) KEY IS PRESSED TWICE, THEN THE (NEXT) KEY.

CALENDAR MODE



REGISTER 9: DISPLAY POSITION

IN THE CALENDAR MODE THE (UP) KEY ALLOWS YOU TO LOOK FORWARD MONTH YEAR UP TO (2099), AND THE (DOWN) KEY ALLOWS YOU TO GO BACK MONTH - YEAR TO (1984). THE (STOP) KEY BRINGS YOU BACK TO THE CURRENT MONTH / DAY.

REGISTER 1: **PRESS (LOAD) TWICE, THEN (NEXT) SET TIME.** (DOWN) IS HRS AND (UP) IS MIN



REGISTER 2: (NEXT) **TIME FORMAT** (DOWN) IS DOWN AND (UP) IS UP



REGISTER 3: (NEXT) **SET DATE** (DOWN) IS MONTH AND (UP) IS DAY



REGISTER 4: (NEXT) **SET YEAR** (DOWN) IS DOWN AND (UP) IS UP



REGISTER 5: (NEXT) **SET ZONE** (DOWN) IS DOWN AND (UP) IS UP



REGISTER 6: (NEXT) **SET DAYLIGHT** (DOWN) IS DOWN AND (UP) IS UP



REGISTER 7: (NEXT) **SET BRIGHTNESS** (DOWN) IS DOWN AND (UP) IS UP



REGISTER 8: (NEXT) **DRIFT CORRECTION** (DOWN) IS DOWN AND (UP) IS UP



REGISTER 2: **TIME FORMAT** (REW) IS DOWN AND (FF) IS UP

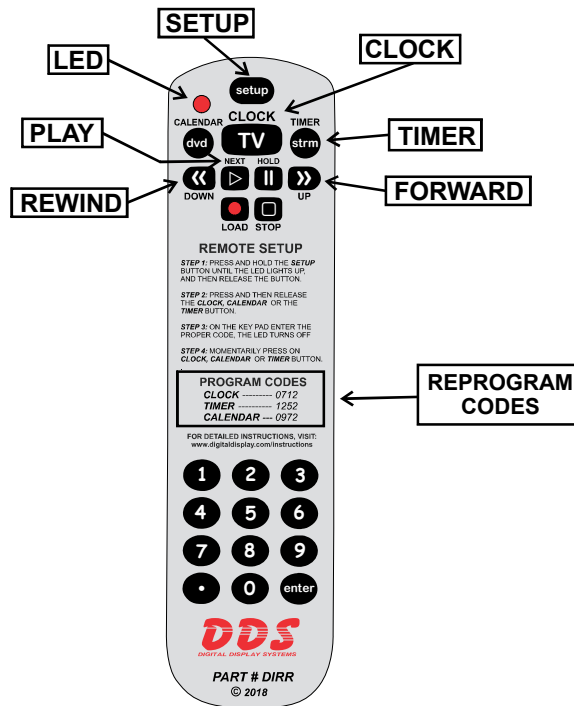

IF THE BATTERIES ARE REPLACED REPROGRAM THE REMOTE CONTROL

- STEP 1:** PRESS AND HOLD THE (SETUP) BUTTON UNTIL THE LED STAYS ON, THEN RELEASE.
- STEP 2:** PRESS AND RELEASE THE (CLOCK) BUTTON.
- STEP 3:** ON THE KEY PAD PRESS 0712. AFTER YOU PRESS THE LAST DIGIT, THE LED TURNS OFF.